



Construction Update No. 1 Pamela Park Neighborhood Roadway Improvements City of Edina Contract No. ENG 10-2

April 13, 2010

Last year, you were invited to attend three meetings related to the Pamela Park Neighborhood Roadway Improvements (project) as listed below:

1. An open house on September 14, 2009, to discuss a typical roadway reconstruction project.
2. An informational meeting on November 16, 2009, to specifically discuss the improvements related to your neighborhood.
3. The Public Improvement Hearing on December 15, 2009, where the City Council (Council) authorized the creation of bid documents for the project.

On April 6, the Council awarded the project to Midwest Asphalt Corporation (contractor).

Schedule

Private Utilities: Please recall from the informational meeting that CenterPoint Energy (CPE) need to update portions of their system prior to the contractor starting street construction operations.

During the week of April 12, CPE will begin replacing steel gas mains and service pipes with plastic gas mains and service pipes in Phase 1 shown on the enclosed construction phasing map. Work will then move to Phase 2. The steel gas main and service pipes on Kellogg Avenue between West 58th Street and 60th Street were already replaced by CPE.

Midwest Asphalt will begin reconstructing Phase 1 streets (see enclosed map) during the week of May 3. They will not be able to start a new phase until specific work items are complete in the current phase. This ensures that the entire project is not under construction at once. Please keep in mind schedules are dependent on the weather.

Safety

Please remind your children to stay away from construction sites, construction machinery, and stockpiled materials. These sites, machines, and materials can be dangerous. Job site safety is our number one concern.

Who to Contact in an Emergency:

During a life or property-threatening emergency, call 911. If construction equipment or

City Hall

4801 WEST 50TH STREET
EDINA, MINNESOTA, 55424-1394

www.cityofedina.com

952-927-8861
FAX 952-826-0390
TTY 952-826-0379

materials need to be moved as part of dealing with the emergency, 911 has a list of emergency contacts for the contractor.

Who to Contact with Questions and Concerns

Please call me, Chad Millner at SEH, with your questions and concerns. My telephone number and email address are 952.912.2633 and cmillner@sehinc.com. If you get my voice mail when you call, please leave a message. I check my voice mail regularly throughout the day, and even on the weekends.

If I do not have an answer for you, I will route your question or concern to the City, the contractor, or other SEH staff members. Once I have your answer, I will contact you at my earliest convenience.

You may also contact your City Utility Engineer, Jesse Struve, at 952.903.5713 or jstruve@ci.edina.mn.us.

Communications

The main tool for communicating with you about this project will be the City Extra e-mail notification service. Updates sent by US mail like this one will occur only a couple of times throughout the project.

The City Extra service is free and allows you to sign up to receive e-mail messages from the City regarding this project. To sign up for the service go to the City Extra website at <http://cityextra.cityofedina.com>. Any information you provide will be confidential, and only specific information you request will be sent to you. Your subscriptions are protected by your own personal password.

All of the correspondences we send to you will be archived on the City's website at http://www.ci.edina.mn.us/Departments/L5_ConstructionProjects_BA360PamelaPark.htm.

Special Events

Please contact me now if you have any special events planned this summer that may require special access to your home during construction activities. Such activities could be graduation parties, garage sales, weddings, medical deliveries, house moves, large home remodeling projects, etc. The contractor will work with you as best they can to accommodate your event into their construction schedule.

Thank you for your patience during this process.

Sincerely

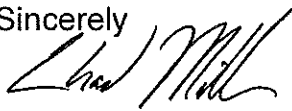

Chad Millner, SEH
Project Engineer

58TH STREET



NTS



NOT IN PROJECT

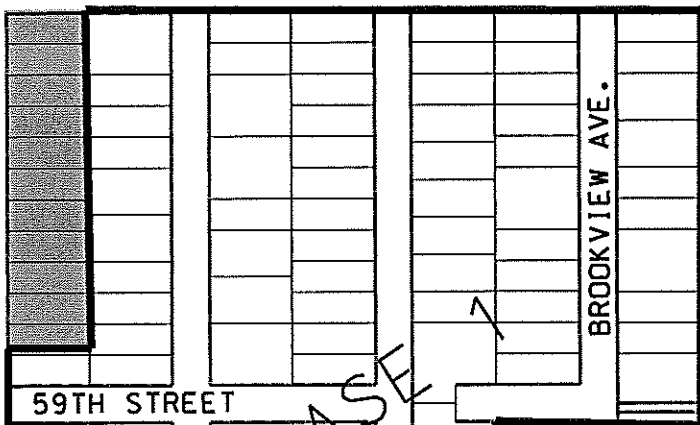

59TH STREET

WOODDALE AVE.

KELLOGG AVE.

BROOKVIEW AVE.

60TH STREET

PAMELA PARK

OAKLAWN AVE.

LIMITS OF CONSTRUCTION

61ST STREET

PHASE 2

BROOKVIEW AVE.

VALLEY VIEW ROAD

62ND STREET

P:\MKTG\Edina\10707\CON\Construction Update\Phasing Plans.dgn

3/22/09 PM

4/2/2009



PHONE: (952)912-2800
10901 RED CIRCLE DR, STE 200
MINNETONKA, MN 55343

PROJECT NO.
EDINA 110176

DATE:
04/12/10

CONSTRUCTION PHASING MAP