



SANITARY SEWER SERVICE MEETING UPDATE

Date: February 18, 2011

Re: Private Sanitary Sewer Service Pipe Reconstruction Update

To: Property Owners of the Minnehaha Woods Neighborhood Roadway Improvement Project No. BA334

On February 10, 35 property owners attended the Private Sanitary Sewer Service Pipe (pipe) Reconstruction Meeting. The presentation delivered by City staff and the City's consultant – SEH is now available on the City's website for this project (http://www.ci.edina.mn.us/Departments/L5_ConstructionProjects_BA334MinnehahaWoods.htm).

We have summarized the two key points from this meeting below:

- The estimated special assessment to reconstruct your pipe using the City's contractor is \$4,500. This only includes the pipe segment from the trunk sanitary sewer pipe to the right-of-way line or your front property line. This amount is included in your total estimated special assessment of \$16,300 per residential equivalent unit (REU). You can avoid being special assessed the \$4,500 if you have this section of your sanitary sewer service pipe upgraded prior to the dates shown on the map included with this packet, or if you can prove that your pipe segment was upgraded within the last 15-years.
- City staff has learned since the Public Hearing that you may special assess your cost of replacing both segments of your sanitary sewer service pipe. The process for this will be:
 1. Obtain a quote or quotes from a plumber(s) to rehabilitate your sanitary sewer service pipe.
 2. Forward the proposal of your chosen contractor to:

Sharon Allison
City of Edina - Engineering Department
7450 Metro Boulevard
Edina, MN 55439
 3. The City will prepare an agreement that the property owner will be required to sign that states the cost for this repair will be added to the proposed special assessment for the roadway cost and the property owner will then waive their rights to the final special assessment hearing. The guaranty and warranty for this sewer service will be between you and your contractor.
 4. The City will issue your contractor a purchase order number once the agreement is signed.
 5. Your contractor will then perform the work.
 6. Your contractor will then invoice the City for this work.
 7. This cost will then be added to the final special assessed roadway cost under the same terms as the special assessed roadway cost.

Please note that if you have your water service replaced at this time you may also add this to the special assessment for your property – using the same procedure as above.

If you have questions, please contact Toby Muse with SEH Inc. at 952-912-2616 or tmuse@sehinc.com or the City's Utility Engineer Jesse Struve at 952-903-5713 or jstruve@ci.edina.mn.us or Edina Public Works Office Manager - Sharon Allison at 952-826-0449 or sallison@ci.edina.mn.us.

Thank you,

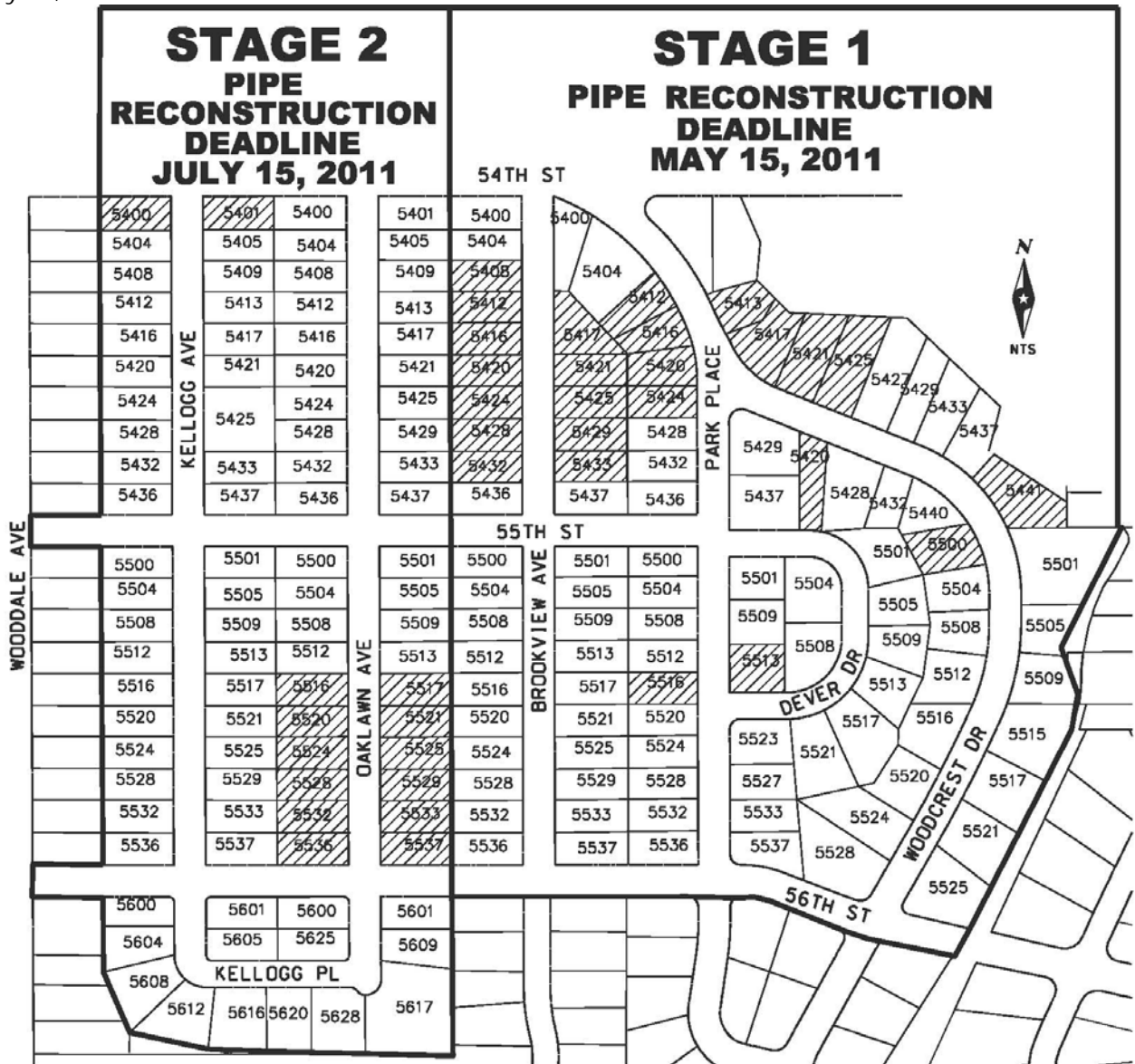

LEGEND

PROJECT STAGE LIMITS

AREA OF TYPE I RECONSTRUCTION

AREA OF TYPE II RECONSTRUCTION

