

# City of Edina & SEH

---

January 18, 2011

Public Improvement Hearing

**Minnehaha Woods Neighborhood**

**Roadway Improvements**

**BA-334**



# Project Details

## Initiation & Issues:

- Initiated by City's Engineering and Utility Departments to update aging street infrastructure



# Project Details

## Existing Conditions - Streets:

- Streets constructed from the early 1940's to the early 1960's.
- ~18% neighborhood has curb and gutter
- Existing street width varies from 24-ft to 30-ft
- Silty sand or lean clay soils



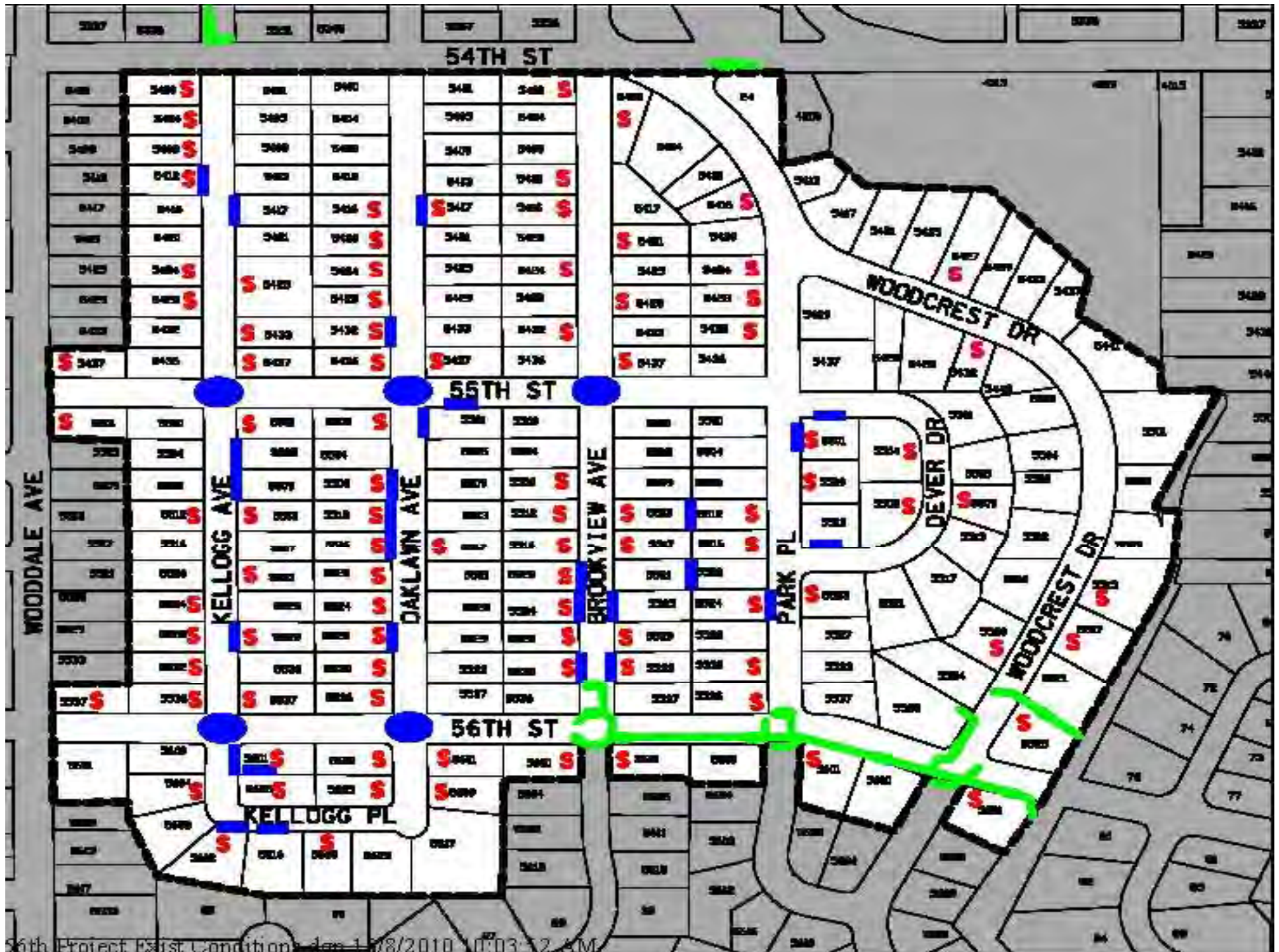

**KEYED NOTES:**

- Ⓐ WATER MAIN SERVICE PIPE RECONSTRUCTION BY CITY
- Ⓑ POSSIBLE WATER MAIN SERVICE PIPE RECONSTRUCTION BY RESIDENT
- Ⓒ SANITARY SEWER SERVICE PIPE RECONSTRUCTION BY CITY
- Ⓓ POSSIBLE SANITARY SEWER SERVICE PIPE RECONSTRUCTION BY RESIDENT

 SERVICE PIPE OWNED BY RESIDENT

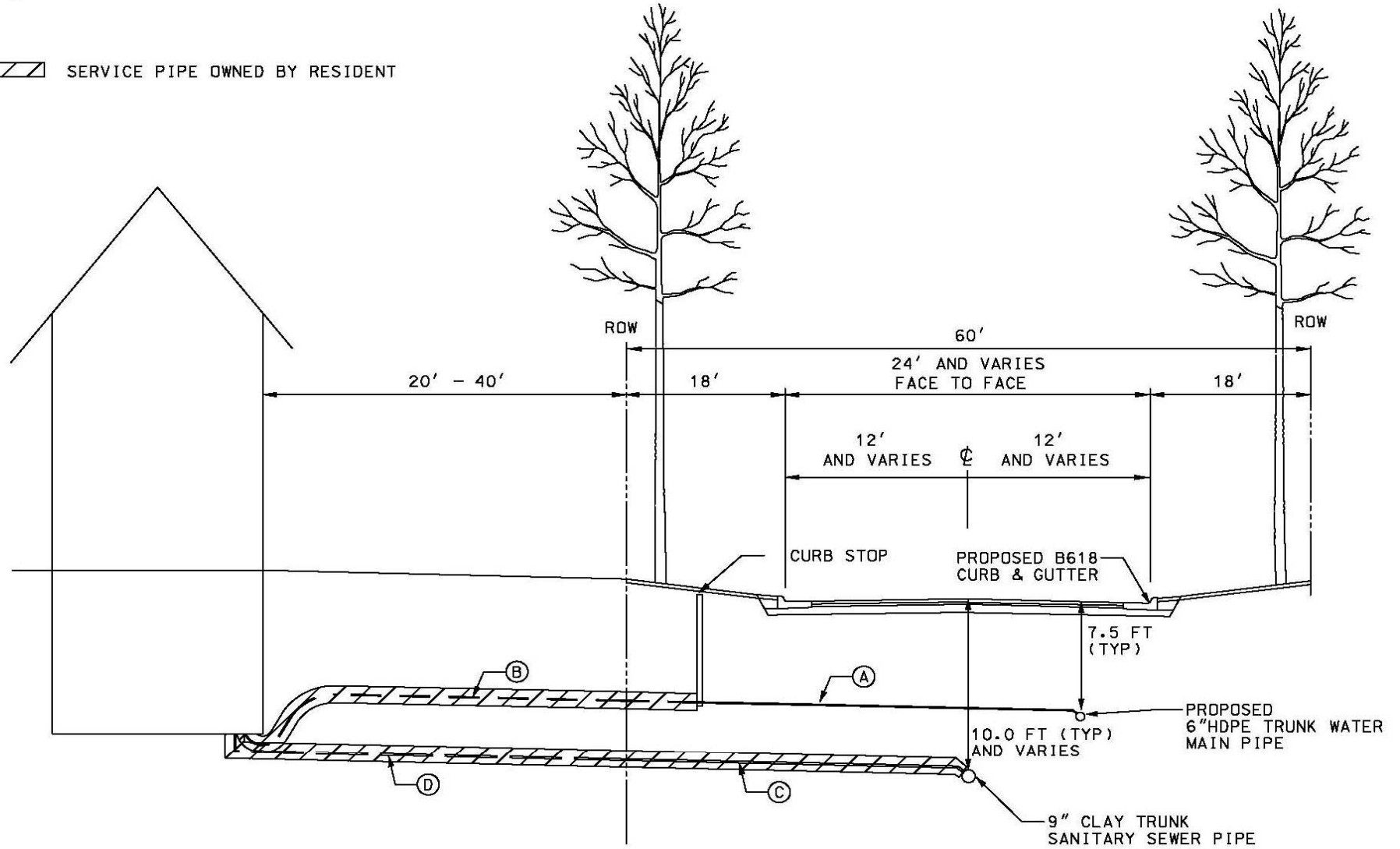

# Project Details

## Existing Conditions- Trunk Water Main Pipe

- 48 trunk water main and service repairs since 1989.



City of Edina  
Minnehaha Woods BA334  
Watermain & Service Breaks

- Main
- Service

  
 Engineering Dept  
 September, 2010



**KEYED NOTES:**

- Ⓐ WATER MAIN SERVICE PIPE RECONSTRUCTION BY CITY
- Ⓑ POSSIBLE WATER MAIN SERVICE PIPE RECONSTRUCTION BY RESIDENT
- Ⓒ SANITARY SEWER SERVICE PIPE RECONSTRUCTION BY CITY
- Ⓓ POSSIBLE SANITARY SEWER SERVICE PIPE RECONSTRUCTION BY RESIDENT

 SERVICE PIPE OWNED BY RESIDENT

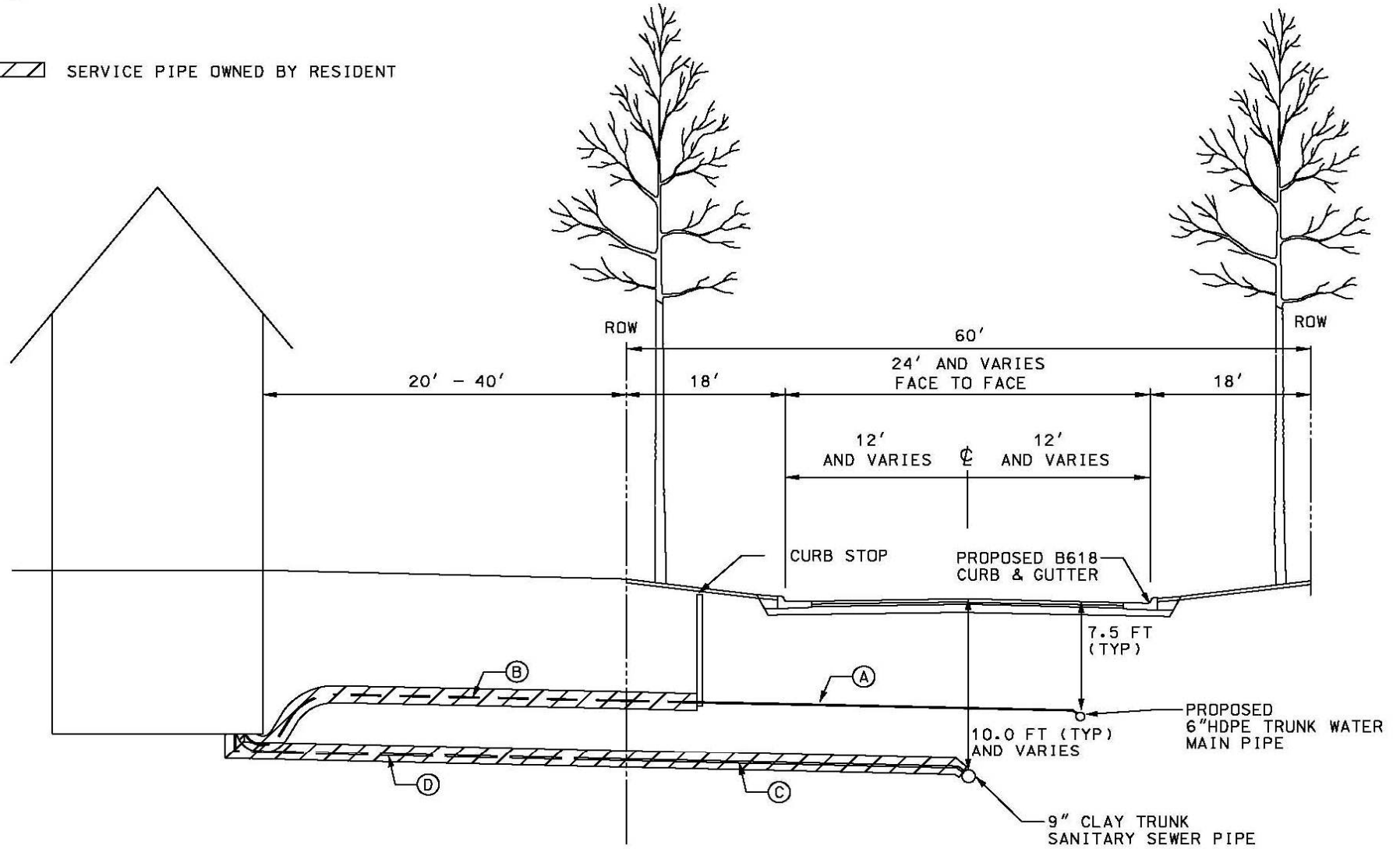

# Project Details

## Existing Conditions – Private Utilities:

- Steel gas main and service pipes
- Private utilities such as electric, telephone, cable TV, etc.



# Project Details

## Proposed Improvements - Streets:

- Street width to remain approximately the same
- Barrier concrete curb and gutter along all streets
- Concrete driveway aprons
- No sidewalks



## Proposed Improvements - Utilities:

- Extend storm sewer system
- Install sump pump drain pipe to address groundwater flow issues
- Replace all trunk water main pipe via pipe bursting method
- Replace all the water service pipe up to and including the curb stop and hydrants via open cut method
- Replace all trunk sanitary sewer pipe via cured in place pipe lining method
- Center Point Energy will replace all trunk gas main pipe and gas service pipe
- No street lighting upgrades
- Replace the sanitary sewer service pipe within the right-of-way

## Preliminary Project Costs

### Summary of Total Estimated Project Cost

ITEM	ESTIMATED COST <sup>2</sup>	
	CITY	RESIDENTS
Sanitary Sewer Trunk Pipe	\$175,000	
Sanitary Sewer Service Pipe Between the Trunk Pipe and the Right-Of-Way line <sup>1</sup>		\$861,000
Water Main Trunk Pipe and Service Pipe Up To and Including Curb Stop Box	\$2,215,000	
Storm Sewer	\$1,100,000	
Street Reconstruction <sup>1</sup>		\$2,260,000
<b>Sub-total</b>	<b>\$3,490,000</b>	<b>\$3,121,000</b>
<b>Total</b>	<b>\$6,611,000</b>	

<sup>1</sup> Cost to be assessed to residents

<sup>2</sup> Costs are given in 2011 dollar



## Preliminary Assessments

### Summary of Total Estimated Assessment Rates per REU

ITEM	ESTIMATED ASSESSMENT <sup>1</sup>
Sanitary Sewer Service Pipe Between the Trunk Pipe and the Right-Of-Way line	\$4,500
Street Reconstruction	\$11,800
<b>Total</b>	<b>\$16,300</b>





<sup>1</sup> Assessment rate is given in 2011 dollars

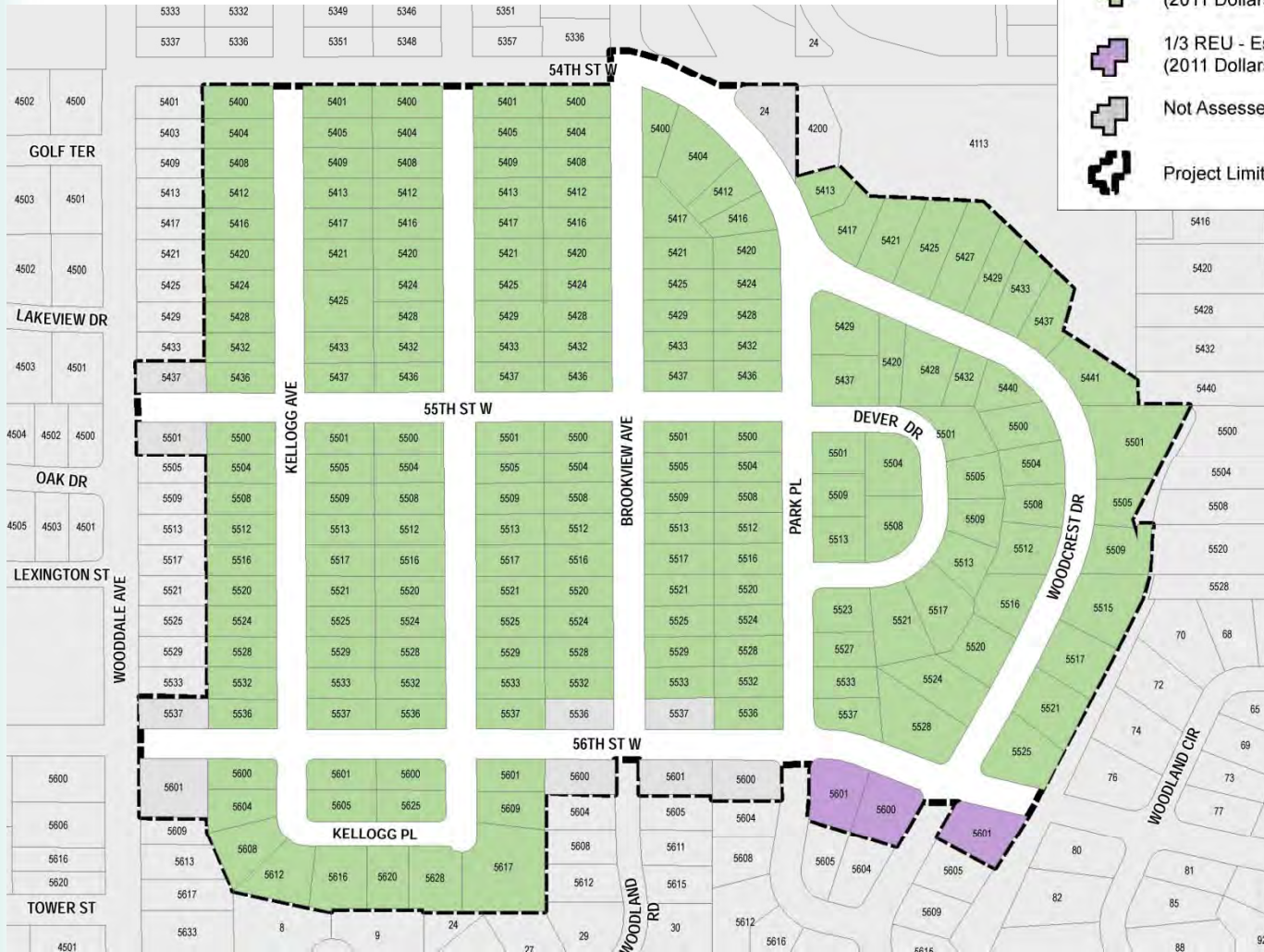

## Preliminary Assessments



**Legend**

-  1 REU - Estimated \$16,300 Assessment (2011 Dollars)
-  1/3 REU - Estimated \$3,935 Assessment (2011 Dollars)
-  Not Assessed
-  Project Limits

**191 REU's**  
**\$16,300/REU**  
**3 1/3 REU's**  
**\$3,933/REU**

# Project Schedule

## Anticipated Schedule

<b>Open House Meeting</b>	<b>Sept. 20, 2010</b>
<b>Informational Meeting</b>	<b>Dec. 9, 2010</b>
<b>Public Hearing</b>	<b>Jan. 18, 2011</b>
<b>Bid Opening</b>	<b>March 2011</b>
<b>Award Contract</b>	<b>April 2011</b>
<b>Begin Construction</b>	<b>May 2011</b>
<b>Complete Construction</b>	<b>Fall 2011</b>
<b>Final Assessment Hearing</b>	<b>2012</b>



CITY OF EDINA

**Thank You!**

