



City of Edina

## Construction Update No. 1C

### Minnehaha Woods Neighborhood Roadway Improvements

City of Edina Contract No. ENG 11-5

June 15, 2011

This update is for homeowners who live on Woodcrest Drive between Park Place and 5500 Woodcrest Drive.

The City's contractor, Palda and Sons, Inc. (Palda), will be closing a segment of Woodcrest Drive on Saturday June 18 from 8 am to 5 pm to install sanitary sewer and water service pipe connections to the sanitary sewer and water main trunk pipes. A map showing the closed segment is on page 2 of this update.

During the closure, there will be no vehicle access to your driveways. If you need to get your vehicle out of your driveway between the hours of 8 am and 5 pm on Saturday, please remove your vehicles from your driveways prior to 8 am on Saturday and park either on Park Place or south of the closure on Woodcrest Drive.

#### **Project Contacts**

Please call me, Carter Schulze at SEH, with your questions and concerns. My telephone number and email address are 612.598.4254 and [cschulze@sehinc.com](mailto:cschulze@sehinc.com). If you get my voice mail when you call, please leave a message. I check my voice mail regularly throughout the day, and even on the weekends.

Thank you for your patience during this process.

Sincerely

Carter Schulze, RPR  
SEH Resident Project Representative

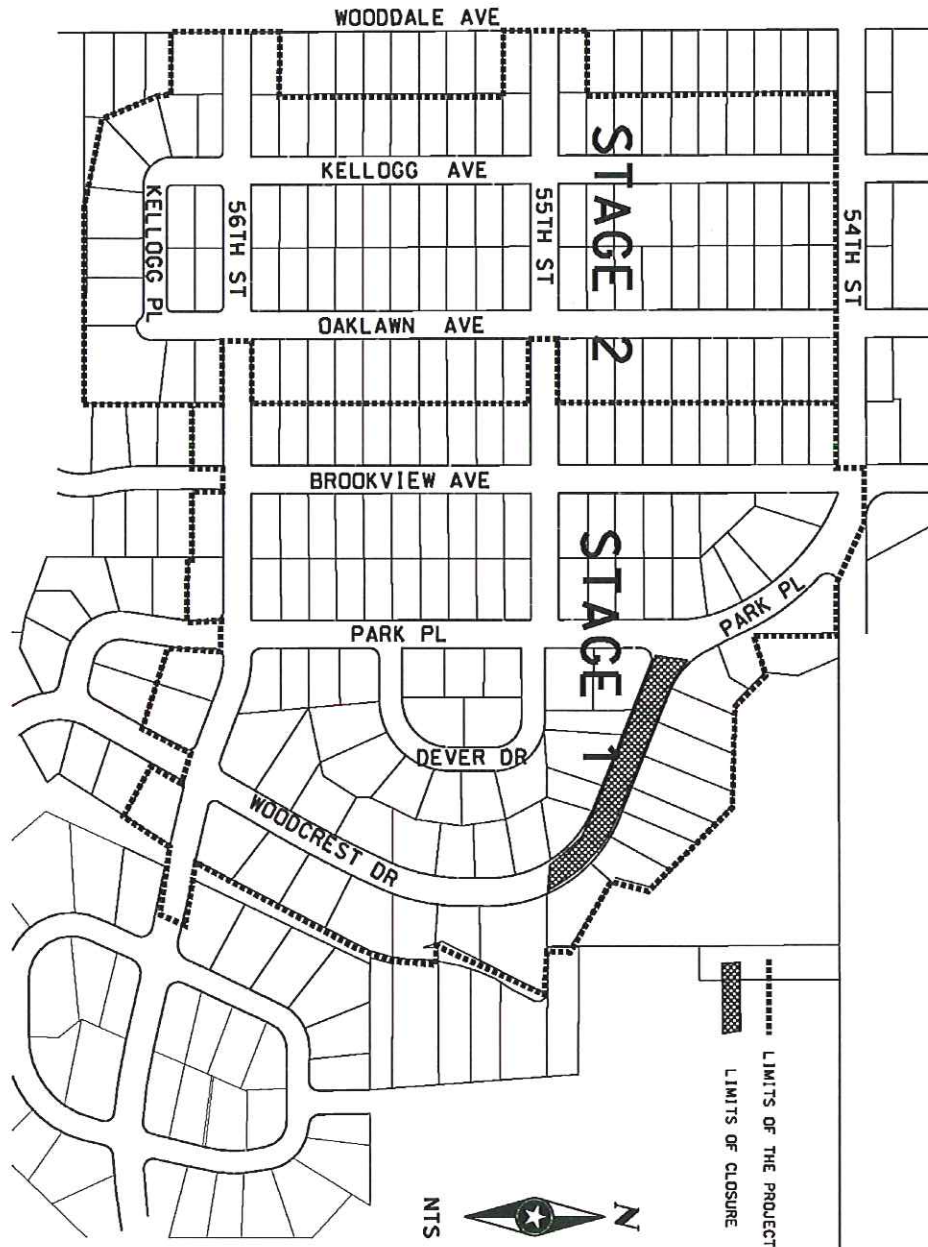

06/18/11 11:52 AM C:\Users\james\Documents\113734\113734.dwg

 PHONE: (352)92-2600  
 1090 RED CIRCLE DR, STE 300  
 MINNETONKA, MN 55343

PROJECT NO.  
 EDINA 113734

DATE:  
 06/18/11

CONSTRUCTION PHASING MAP